

Connector blocks

- used with receptacles and tabs with locking lip 1,5 - 6 mm²
- material PA (nylon) transparent
- max voltage 250 VAC

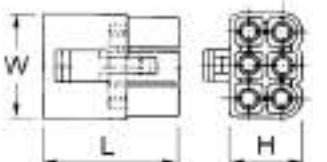
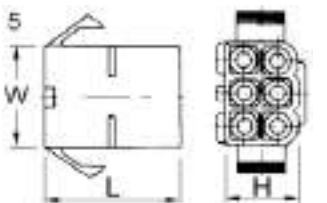
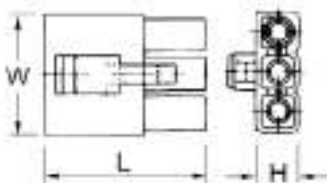
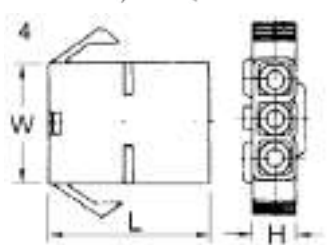
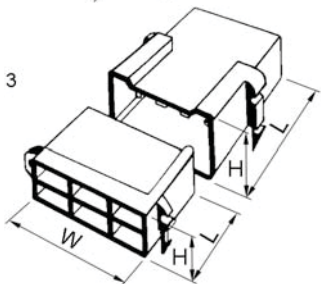
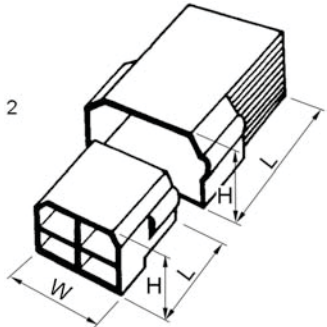
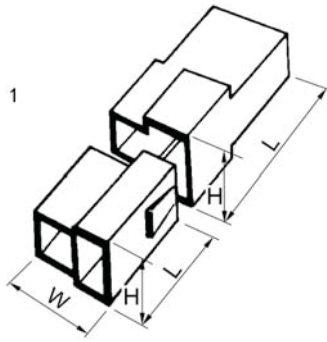

Fig	Cat. no.	No. of terminals	mm L	W	H	Pcs/ pack	Note
1	408-2-M	2	24	16,4	9,7	100	1
2	408-4-M	4	24	28	15,3	100	1
3	408-6-M	6	29	29	15,2	100	1
-	408-8-M	8	34	38	15,6	100	1
1	408-2-F	2	32	20	12,7	100	2
2	408-4-F	4	33	23	17,4	100	2
3	408-6-F	6	33	31	18,7	50	2
-	408-8-F	8	33	40	18,6	25	2

Note

- 1 Used with receptacles B2507FLSN and B4607FLSN.
- 2 Used with tabs B2507HN and B4607HN.

Connector blocks

- used together with sockets and bullets 0,2 - 1,5 mm²
- material PA (nylon) transparent
- rated voltage 250 VAC
- max current 20 A
- temperature range -20° C to +105° C

Fig	Cat. no.	Pol	mm L	W	H	Pcs/ pack	Note
-	MC02F	2	27	13,6	7,3	100	3
-	MC02M	2	27	13,5	7,3	100	4
4	MC03F	3	27	19,6	7,2	100	3
4	MC03M	3	27	19,6	7,1	100	4
-	MC04F	4	27	13,5	13,5	100	3
-	MC04M	4	27	13,5	13,5	100	4
5	MC06F	6	27	19,6	13,4	100	3
5	MC06M	6	27	19,6	13,4	100	4
-	MC09F	9	27	19,7	19,7	100	3
-	MC09M	9	27	19,7	19,7	100	4
-	MC12F	12	27	26	19,6	50	3
-	MC12M	12	27	26	19,7	50	4
-	MC15F	15	27	32	19,6	50	3
-	MC15M	15	26	32	19,9	50	4

Note

- 3 Used with bullets B0502HA and B1502HA.
- 4 Used with sockets B0502HO and B1502HO.