

Aluminium-copper through connectors 16 - 400 mm²

- Connector from Al conductor to Cu conductor.
- Stranded/solid Al conductors, stranded/multi-stranded Cu conductors.
- For multi-stranded Cu conductors, contact crimping using the DUAL system is recommended.
- Two crimps are required for Al (see image) normally one for Cu.
- When hexagonally crimping the Cu part, the dies are placed between the marking groove and the outer edge.

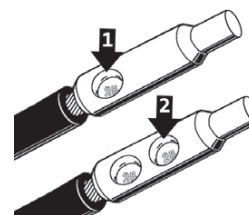
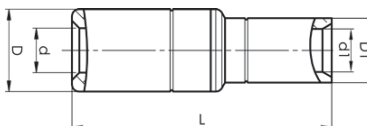

Crimp sequence

Stranded Al mm ²	Solid Al mm ²	Cu mm ²	AWG/MCM	AWG Al (Solid Al)	AWG Cu (AlCu)	Name	d	d1	D	D1	L	s	s1	Tool	Pcs/pack	
16-25		10-16	6-4		8-6	AKS1625-1016	6,2	6	8,3	7,5	36,5	19	17	V600	48	
16	25 (16)	10	6	4	8	AKS16-10	5,9	5	13	8	45,5	29	14	V600, DV1300, DV250	48	
25	35	10	4	2	8	AKS25-10	6,8	5	13	8	45,5	29	14	V600, DV1300, DV250	48	
25	35	16	4	2	6	AKS25-16	6,8	6	13	9	45,5	29	15	V600, DV1300, DV250	48	
35	50	10	2	1/0	8	AKS35-10	8,5	5	20	8	66	45	14	DV1300, DV250	24	
35	50	16	2	1/0	6	AKS35-16	8,5	6	20	13	66	45	15	DV1300, DV250	24	
35	50	25	2	1/0	4	AKS35-25	8,5	8	20	13	69	45	17	DV1300, DV250	24	
50	70	10	1/0	2/0	8	AKS50-10	9,6	5	20	13	66	45	14	DV1300, DV250	24	
50	70	16	1/0	2/0	6	AKS50-16	9,6	6	20	13	66	45	15	DV1300, DV250	24	
50	70	25	1/0	2/0	4	AKS50-25	9,6	8	20	13	69	45	17	DV1300, DV250	24	
50	70	35	1/0	2/0	2	AKS50-35	9,6	9	20	13	71	45	19	DV1300, DV250	24	
50	70	50	1/0	2/0	1/0	AKS50-50	9,6	11	20	14,5	75,5	45	23	DV1300, DV250	24	
70	95	35	2/0	4/0	2	AKS70-35	11,3	9	20	13	71	45	19	DV1300, DV250	24	
70	95	50	2/0	4/0	1/0	AKS70-50	11,3	11	20	14,5	75,5	45	23	DV1300, DV250	24	
70	95	70	2/0	4/0	2/0	AKS70-70	11,3	13	20	17	78	45	25	DV1300, DV250	24	
95	120	10	4/0	250	8	AKS95-10	12,5	5	25	17	81	60	14	DV1300, DV250	24	
95	120	16	4/0	250	6	AKS95-16	12,5	6	25	17	81	60	15	DV1300, DV250	24	
95	120	25	4/0	250	4	AKS95-25	12,5	8	25	17	84	60	17	DV1300, DV250	24	
95	120	35	4/0	250	2	AKS95-35	12,5	9	25	17	86	60	19	DV1300, DV250	24	
95	120	50	4/0	250	1/0	AKS95-50	12,5	11	25	17	90,5	60	23	DV1300, DV250	24	
95	120	70	4/0	250	2/0	AKS95-70	12,5	13	25	17	93	60	25	DV1300, DV250	24	
95	120	95	4/0	250	4/0	AKS95-95	12,5	15	25	20	93,5	60	25	DV1300, DV250	24	
120	150	50	250	300	1/0	AKS120-50	14	11	25	17	90,5	60	23	DV1300, DV250	24	
120	150	70	250	300	2/0	AKS120-70	14	13	25	17	93	60	25	DV1300, DV250	24	
120	150	95	250	300	4/0	AKS120-95	14	15	25	20	93,5	60	25	DV1300, DV250	24	
120	150	120	250	300	250	AKS120-120	14	17	25	22	103,560	30	20	DV1300, DV250	24	
150	185	25	300	350	4	AKS150-25	15,8	8	25	17	84	60	17	DV1300, DV250	24	
150	185	35	300	350	2	AKS150-35	15,8	9	25	17	86	60	19	DV1300, DV250	24	
150	185	50	300	350	1/0	AKS150-50	15,8	11	25	17	90,5	60	23	DV1300, DV250	24	
150	185	70	300	350	2/0	AKS150-70	15,8	13	25	17	93	60	25	DV1300, DV250	24	
150	185	95	300	350	4/0	AKS150-95	15,8	15	25	20	93,5	60	25	DV1300, DV250	24	
150	185	120	300	350	250	AKS150-120	15,8	17	25	22	103,560	30	20	DV1300, DV250	24	
150	185	150	300	350	300	AKS150-150	15,8	19	25	25	99	60	30	DV1300, DV250	24	
185	240	70	350	500	2/0	AKS185-70	17,6	13	32	17	93,5	61	25	DV1300, DV250	12	
185	240	95	350	500	4/0	AKS185-95	17,6	15	32	20	94	61	25	DV1300, DV250	12	
185	240	120	350	500	250	AKS185-120	17,6	17	32	22	104	60	30	DV1300, DV250	12	
185	240	150	350	500	300	AKS185-150	17,6	19	32	25	99,5	61	30	DV1300, DV250	12	
185	240	185	350	500	350	AKS185-185	17,6	21	32	27	100	61	30	DV1300, DV250	12	
240		35	500		2	AKS240-35	19,8	9	32	17	86,5	61	19	DV1300, DV250	12	
240		50	500		1/0	AKS240-50	19,8	11	32	17	91	61	23	DV1300, DV250	12	
240		70	500		2/0	AKS240-70	19,8	13	32	17	93,5	61	25	DV1300, DV250	12	
240		95	500		4/0	AKS240-95	19,8	15	32	20	93,5	61	25	DV1300, DV250	12	
240		120	500		250	AKS240-120	19,8	17	32	22	104	60	30	DV1300, DV250	12	
240		150	500		300	AKS240-150	19,8	19	32	25	99,5	60	30	DV1300, DV250	12	
240		185	500		350	AKS240-185	19,8	21	32	27	100	61	30	DV1300, DV250	12	
240		240	500		500	AKS240-240A	19,8	22,5	32	29	100	61	30	DV1300, DV250	12	
300		150	600		300	AKS300-150	22	19	36	25	122,583	30		DV250	9	
300		185	600		350	AKS300-185	22	21	36	27	123	83	30		DV250	9
300		240	600		500	AKS300-240A	22	22,5	36	29	123,583	30		DV250	9	
400	300	300		600	600	AKS300SOLID-300	20	26	36	32	124	83	30		DV250	6
400		150	750		300	AKS400-150	25	19	40	25	124	83	30		DV250	6
400		185	750		350	AKS400-185	25	21	40	27	124	83	30		DV250	6
400		240	750		500	AKS400-240A	25	22,5	40	29	124	83	30		DV250	6
400		300	750		600	AKS400-300A	25	24,5	40	31,5	125	83	30		DV250	6

s = strip length (Al), s1 = strip length (Cu)

05

