

Multiple tabs, rolled type (piggy back) 0.5 - 2.5 mm²

• Material: brass/Cu, tin plated Cu/Sn.

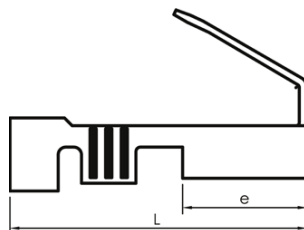

mm ² (Cu)	AWG Cu	Name	t mm	e	L	s	For tab	Tool	Pcs/pack
0,5-1,5	20-16	B1507FLSH	0,4	8	20	7	6,3x0,8	GRB0560	100
1,5-2,5	16-14	B2507FLSH	0,4	8	20	7	6,3x0,8	GRB0560	100

t = metal thickness, s = strip length

Receptacles 90° rolled type 0.5 - 1.5 mm²

• Material: brass/Cu, tin plated Cu/Sn.

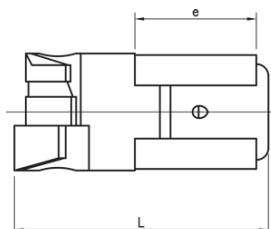

mm ² (Cu)	AWG Cu	Name	t mm	e	L	s	For tab	Tool	Pcs/pack
0,5-1,5	20-16	B1507FLSB8	0,4	7,7	13	7	6,3x0,8	TRB0515B	100

t = metal thickness, s = strip length

Receptacle angled rolled type 0.5 - 1 mm²

• Material: brass/Cu, tin plated Cu/Sn.

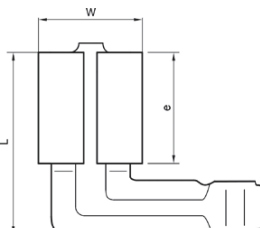

mm ² (Cu)	AWG (Cu)	Name	W mm	t	e	L	s	For tab	Tool	Pcs/pack
0,5-1	20-18	B1003FLSV5	3,8	0,3	4,9	9,3	7	2,8x0,5	DRB0115	100

t = metal thickness, s = strip length