

KSxP parallel connectors for conductors total 10 - 630 mm²

- Material: Cu 99.95%, tin plated Cu/Sn.
- For stranded (class 2) and multi-stranded (class 5) Cu conductors.
- For multi-stranded Cu conductors Elpress recommends the Dual system.

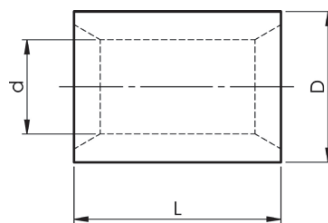

04

mm ² (Cu)	AWG Cu	Name	d mm	D	L	Tool	Pcs/ pack	Die
7-12	8	KS10P	5	8	11	PVL350, V600, DV1300, DV250	250	8
12,5-18,5	6	KS16P	6	9	12	PVL350, V600, DV1300, DV250	250	9
20-31	4	KS25P	8	11	14	PVL350, V600, DV1300, DV250	200	11
31-41	2	KS35P	9	13	16	PVL350, V600, DV1300, DV250	100	13
45-56	1/0	KS50P	11	14,5	18	PVL350, V600, DV1300, DV250	100	14,5
60-85	2/0	KS70P	13	17	18	PVL350, V600, DV1300, DV250	100	17
86-111	4/0	KS95P	15	20	20	V600, DV1300, DV250	100	20
111-130	250	KS120P	17	22	26	V600, DV1300, DV250	100	22
136-166	300	KS150P	19	25	26	V600, DV1300, DV250	50	25
170-210	350	KS185P	21	27	28	DV1300, DV250	25	27
220-255	500	KS240P	24	30	30	DV1300, DV250	25	30
300	600	KS300P	26	32	35	DV1300, DV250	10	32
400	750	KS400P	30	38	50	DV1300, DV250	10	38
500	1000	KS500P	33	42	52	DV250, V1470	10	42
630	1250	KS630P	39	50	62	DV250, V1470	10	50

CUT through connectors for single strand conductors 6 - 16 mm²

- Material: Cu 99.95%, tin plated Cu/Sn.
- For single-wire conductors (acc. to IEC 60228 class 1).

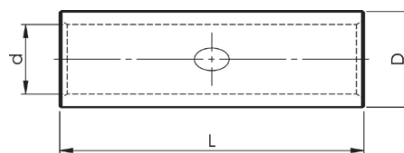

mm ² (Cu)	AWG Cu	Name	d mm	D	L	s	Tool	Pcs/ pack
6	10	CUT6	3	5	27	12	ES2258, T2258	100
10	8	CUT10	4	6	27	12	ES2258, T2258	100
16	6	CUT16	5	8	35	15,5	ES2258, T2258	100

s = strip length

The Elpress logo is included on the marking.