

KS/KSF through connectors 0.75 - 800 mm²

- Material: Cu 99.95%, tin plated Cu/Sn.
- Inspection hole and int. cable stop.
- For stranded (class 2) and multi-stranded (class 5) Cu conductors.
- For multi-stranded Cu conductors Elpress recommends the DUAL system.
- UL approved (1-500 mm²). DNV approved (16-400 mm²).



Examples of marking: 20 95F (Elpress logotype is included on the marking.)

20 = Die No. 95 = mm² F = type KSF for stranded and flexible conductors 111 = screen mm²

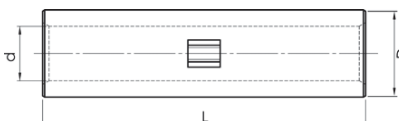

04

mm ² (Cu)	AWG Cu	Name	Screen conductor	d mm	D	L	s	Tool	Pcs/ pack	Die
0,75	(22)-18	KS0,75		1,3	2,8	14	7	DKB0325, DKB0760	100	
1,5	(18)-16	KS1,5		1,8	3,3	14	7	DKB0325, DKB0760	100	
2,5	(16)-14	KS2,5		2,3	4,2	16	8	DKB0325, DKB0760	100	
4	12	KS4		3	5	19	9	GWB4099, ES2258	100	
6	10	KS6		4	6	19	9	GWB4099, ES2258	100	
10	8	KS10		5	8	30	15	GWB4099, ES2258, PVL350, V600, DV1300	100	8
16	6	KSF16	15	6	9	35	17	ES2258, PVL350, V600, DV1300	100	9
25	4	KSF25	21-29	8	11	35	17	ES2258, PVL350, V600, DV1300	100	11
35	2	KSF35	41	9	13	35	17	PVL350, V600, DV1300, DV250	100	13
50	1/0	KSF50	57	11	14,5	45	22	V600, DV1300, DV250	50	14,5
70	2/0	KSF70	72-88	13	17	45	22	V600, DV1300, DV250	50	17
95	4/0	KSF95	111	15	20	45	25	V600, DV1300, DV250	50	20
120	250	KSF120		17	22	55	27	V600, DV1300, DV250	50	22
150	300	KSF150		19	25	65	32	V600, DV1300, DV250	25	25
185	350	KSF185		21	27	70	35	DV1300, DV250	25	27
240	500	KSF240A		22,5	29	70	35	DV1300, DV250	25	30
300	600	KSF300A		24,5	31,5	75	37	DV1300, DV250	10	32
400	750	KSF400A		30	38	100	50	DV1300, DV250	10	38
500	1000	KSF500		33	42	135	68	DV250, V1470	5	42
630	1000	KSF630		39	53	175	88	DV250, V1470	3	53
800	1000	KSF800		42,5	53	175	88	DV250, V1470	2	53

s = strip length