

## KS/KSF through connectors with partition 10-500 mm<sup>2</sup>

- Material: Cu 99.95%, tin plated Cu/Sn.
- For stranded (class 2) and multi-stranded (class 5) Cu conductors.
- For multi-stranded Cu conductors Elpress recommends the DUAL system.
- With partition to prevent oil leakage.
- UL approved (1-500 mm<sup>2</sup>). DNV approved (16-400 mm<sup>2</sup>).



Examples of marking: 20 95F (Elpress logotype is included on the marking.)

20 = Die No. 95 = mm<sup>2</sup> F = type KSF for stranded and flexible conductors 111 = screen mm<sup>2</sup>

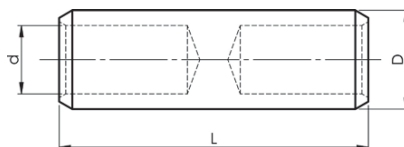

mm <sup>2</sup> (Cu)	AWG Cu	Name	Screen conductor	d mm	D	L	s	Tool	Pcs/ pack	Die
10	8	KS10M		5	8	36	18	ES2258, PVL350, V600, DV1300	100	8
16	6	KSF16M	15	6	9	37	18	ES2258, PVL350, V600, DV1300	100	9
25	4	KSF25M	21-29	8	11	38	18	ES2258, PVL350, V600, DV1300	100	11
35	2	KSF35M	41	9	13	41	19	PVL350, V600, DV1300, DV250	100	13
50	1/0	KSF50M	57	11	14,5	48	22	PVL350, V600, DV1300, DV250	50	14,5
70	2/0	KSF70M	72-88	13	17	49	22	PVL350, V600, DV1300, DV250	50	17
95	3/0	KSF95M	111	15	20	56	25	V600, DV1300, DV250	50	20
120	250	KSF120M		17	22	63	28	V600, DV1300, DV250	50	22
150	300	KSF150M		19	25	64	28	V600, DV1300, DV250	25	25
185	350	KSF185M		21	27	74	32	DV1300, DV250	25	27
240	500	KSF240AM		22,5	29	76	32	DV1300, DV250	1	30
300	600	KSF300AM		24,5	31,5	88	37	DV1300, DV250	1	32
400	750	KSF400AM		30	38	105	45	DV1300, DV250	1	38
500	1000	KSF500M		33	42	135	54	DV250, V1470	1	42

s = strip length