

## KST through connectors with partition 10-500 mm<sup>2</sup>

- Material: Cu 99.95%, tin plated Cu/Sn.
- For stranded (class 2) Cu conductors.
- Cable inspection hole and cable stop.
- UL approved (1-500 mm<sup>2</sup>). DNV approved (16-400 mm<sup>2</sup>).



Examples of marking: 16 70 (Elpress logotype is included on the marking.)

16 = Die No. 70 = mm<sup>2</sup>

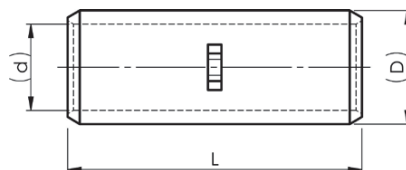

04

mm <sup>2</sup> (Cu)	AWG Cu	Name	d mm	D	L	s	Tool	Pcs/ pack	Die
10	8	KST10	4,5	7	30	15	ES2258, PVL350, V600, V1300	100	7
16	6	KST16	5,5	8,5	35	17	EL2258, PVL350, V600, V1300	100	8,5
25	4	KST25	7	10	40	20	EL2258, PVL350, V600, V1300	100	10
35	2	KST35	8,5	12	45	22	PVL350, V600, V1300, V250	100	12
50	1/0	KST50	10	14	50	25	PVL350, V600, V1300, V250	50	14
70	2/0	KST70	12	16	55	27	PVL350, V600, V1300, V250	50	16
95	4/0	KST95	13,5	18	60	30	V600, V1300, V250	50	18
120	250	KST120	15	19	60	30	V600, V1300, V250	50	19
150	300	KST150	17	22	65	32	V600, V1300, V250	50	22
185	350	KST185	19	24	75	37	V600, V1300, V250	50	24
240	500	KST240	21	26	85	42	V600, V1300, V250	50	26
300	600	KST300	24	30	90	45	V1300, V250	50	30
400	750	KST400	26	32	90	45	V1300, V250	50	32
500	1000	KST500	31	40	135	68	V250, V1470	5	40

s = strip length