

Receptacles fully insulated rolled type 0.5 - 6 mm²

- Material: brass, tin plated Cu/Sn, brazed neck.
- PC and PA insulation has easy-entry, PC and PA are halogen-free.

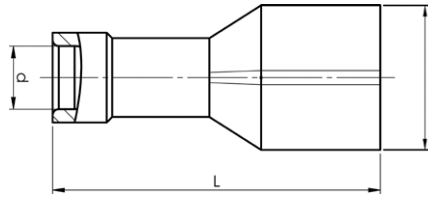

mm ² (Cu)	AWG Cu	Name	W mm	d	L	s	For tab	Insulation material	Neck type	Easy Entry	Pcs/pack
0,5-1,5	20-16	A1503FLSF5	5,5	3,4	19,5	7	2,8x0,5	PA	Reinforcement sleeve	Yes	100
		A1503FLSF8	5	3,4	19,5	7	2,8x0,8	PA	Reinforcement sleeve	Yes	100
		A1505FLSF5	7,2	4,1	19,5	7	4,8x0,5	PA	Reinforcement sleeve	Yes	100
		A1505FLSF8	7,2	4,1	19,5	7	4,8x0,8	PA	Reinforcement sleeve	Yes	100
0,5-1,5	20-16	A1507FLSF	8,8	4	21,3	7	6,3x0,8	PC	Brazed	Yes	100
1,5-2,5	16-14	A2505FLSF5	7,2	4,5	19,5	8	4,8x0,5	PA	Reinforcement sleeve	Yes	100
		A2505FLSF8	7	3,9	19,5	8	4,8x0,8	PA	Reinforcement sleeve	Yes	100
1,5-2,5	16-14	A2507FLSF	8,8	4,5	21,3	8	6,3x0,8	PC	Brazed	Yes	100
4-6	12-10	A4607FLSF	9,2	5,4	26	9	6,3x0,8	PA	Reinforcement sleeve	Yes	100

s = strip length

Blade 0.5 - 6 mm²

- Material: brass, tin plated Cu/Sn, brazed neck.
- PC and PA insulation have easy-entry, PC and PA are halogen-free.

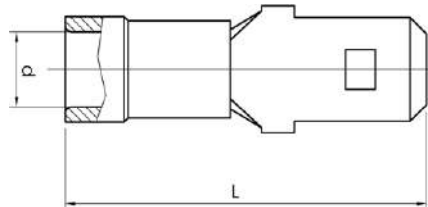

mm ² (Cu)	AWG Cu	Name	d mm	L	s	Tab	Insulation material	Neck type	Easy Entry	Pcs/pack
0,5-1,5	20-16	A1507H	4,1	22	7	6,3x0,8	PC	Brazed	Yes	100
1,5-2,5	16-14	A2507H	5	22,5	8	6,3x0,8	PC	Brazed	Yes	100
4-6	12-10	A4607H	6,6	24,5	9	6,3x0,8	PA	Reinforcement sleeve	No	100

s = strip length