

Hook terminals 0.5 - 2.5 mm²

- Material: Cu 99.95%, tin plated Cu/Sn, brazed neck.
- PC insulation has easy-entry, PC is halogen free.

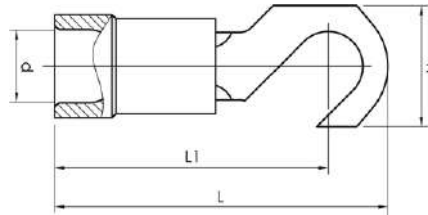

mm ² (Cu)	AWG Cu	Name	Screw	W mm	d	L	L1	t	s	Tool	Insulation material	Easy Entry	Pcs/pack
0,5-1,5	20-16	A1543K	M4	7	4	20,5	17	0,7	7	GSA0760	PC	Yes	100
1,5-2,5	16-14	A2543K	M4	7,5	4,5	21	17	0,8	8	GSA0760	PC	Yes	100

t = palm thickness, s = strip length

Pin terminals 0.1 - 6 mm²

- Material: Cu 99.95%, tin plated Cu/Sn, brazed neck.
- PC insulation has easy-entry, PC and PA are halogen-free.

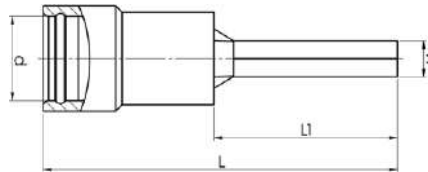

mm ² (Cu)	AWG Cu	Name	W mm	d	L	L1	s	Tool	Insulation material	Easy Entry	Pcs/pack
0,1-0,5	26-20	A0514SR	1,2	2,2	18	8	6	DSA0115	PA	No	100
0,25-0,75	24-20	A0819SR	1,8	3,2	22	12	7	DSA0115	PC	Yes	100
0,25-0,75	24-20	A0819SRK	1,8	3,2	18,5	8,5	7	DSA0115	PC	Yes	100
0,5-1,5	20-16	A1519SR	1,7	4	22	12	7	GSA0760	PC	Yes	100
0,5-1,5	20-16	A1519SRK	1,7	4	18,5	8,5	7	GSA0760	PC	Yes	100
1,5-2,5	16-14	A2519SR	1,9	4,5	21,5	11,5	8	GSA0760	PC	Yes	100
1,5-2,5	16-14	A2519SRK	1,9	4,5	18,5	8,5	8	GSA0760	PC	Yes	100
4-6	12-10	A4630SR	2,7	6,4	27	14	9	GSA0760	PC	Yes	100

s = strip length