

Tab 0.5 - 2.5 mm²

- Material: brass/Cu, tin plated Cu/Sn.

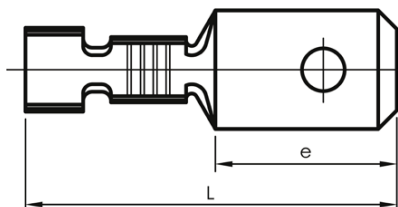

mm ² (Cu)	AWG Cu	Name	e mm	L	s	For tab	Tool	Pcs/pack
0,5-1	20-18	B1003H	5,6	12,7	7	2,8x0,8	DRB0115	100
0,5-1,5	20-16	B1507H	8	19	7	6,3x0,8	GRB0560	100
1,5-2,5	16-14	B2507H	8	20	8	6,3x0,8	GRB0560	100

s = strip length

Tab with locking lip 0.5 - 6 mm²

- Material: brass/Cu, tin plated Cu/Sn.

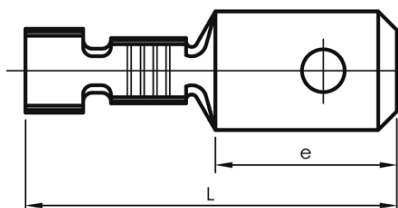
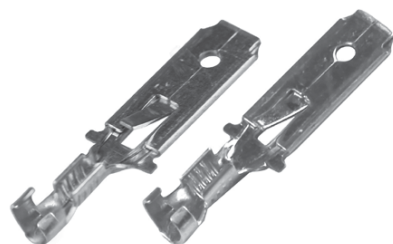

mm ² (Cu)	AWG Cu	Name	e mm	L	s	For tab	Tool	Pcs/pack
0,5-1,0	20-18	B1007HN	16	28	8	6,3x0,8	DRB0115	100
1,5-2,5	16-14	B2507HN	16	28	8	6,3x0,8	GRB0560	100
4-6	12-10	B4607HN	16	28	9	6,3x0,8	GRB0560	100

s = strip length

Bullet and Socket 0.2 - 1.5 mm²

- Material: brass/Cu, tin plated Cu/Sn.
- HA = Male contact
- HO = Female contact

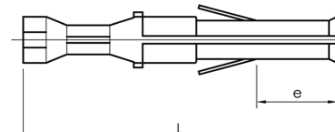
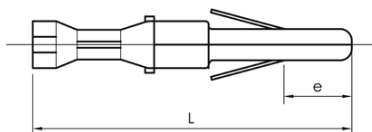

mm ² (Cu)	AWG Cu	Name	e mm	L	s	For bullets Ø	Tool	Pcs/pack
0,2-0,5	24-20	B0502HA	5,5	21	7	2	DRB0115	100
0,5-1,5	20-16	B1502HA	5,5	21	8	2	DRB0115	100
0,2-0,5	24-20	B0502HO	5,5	21	7		DRB0115	100
0,5-1,5	20-16	B1502HO	5,5	21	8		DRB0115	100

s = strip length

