

Low Voltage Universal Branch Joint

(Excludes Connectors)

JBR



Low Voltage Branch Joints - 600/1000V. Suitable for use with SWA cables to BS5467, BS6346 and IEC502 with polymeric insulation and copper and aluminium conductors from 1.5mm² to 300mm².

Features and benefits

- Tested and approved to BS EN 50393 and ENATS TS C81/3.
- Includes a constant force spring armour bond.
- Utilizes Prysmian's low hazard isocyanate free JEM resin.
- Transparent shells which offer greater visibility during installation.
- Can be used with either compression or mechanical connectors (sold separately).



Nominal Conductor Cross Section (mm ²)	Joint Selection		
	Two Core	Three Core	Four Core
1.5	JBR6	JBR6	JBR6
2.5	JBR6	JBR6	JBR6
4	JBR6	JBR6	JBR6
6	JBR6	JBR6	JBR6
10	JBR6	JBR16	JBR16
16	JBR16	JBR16	JBR16
25	JBR16	JBR16	JBR35
35	JBR35	JBR35	JBR35
50	JBR95	JBR95	JBR95
70	JBR95	JBR95	JBR95
95	JBR95	JBR95	JBR95
120	JBR185	JBR185	JBR185
150	JBR185	JBR185	JBR185
185	JBR185	JBR185	JBR185
240	JBR300	JBR300	JBR300
300	JBR300	JBR300	JBR300

Note : JBR joints are provided without connectors. Compression or mechanical connectors can be provided separately.

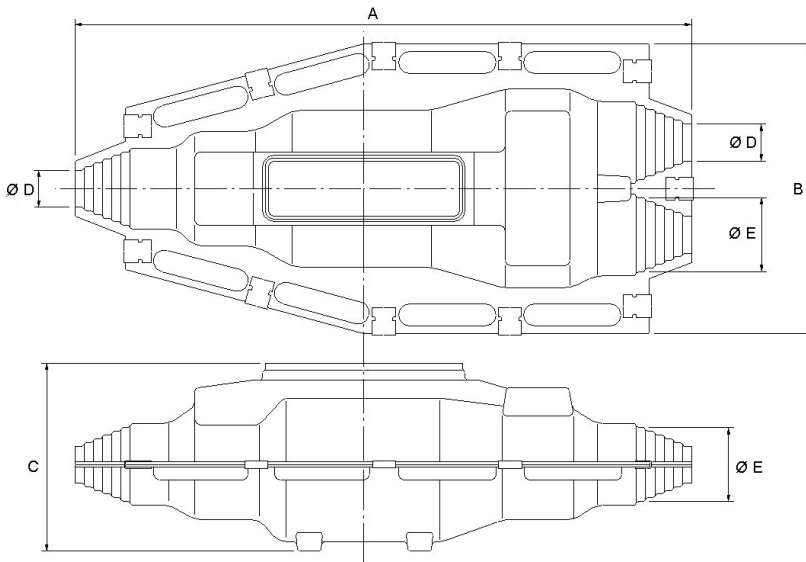

Joint Ref	Shell Dimensions (mm)				
	A	B	C	Min Box Entry ØD	Max Box Entry ØE
JBR6	240	125	75	12	22
JBR16	345	160	95	20	35
JBR35	435	175	100	24	40
JBR95	650	210	190	27	51
JBR185	870	250	230	40	65
JBR300	1020	300	310	55	80