

# Cable Connectors



## Terminals for Medium Voltage Cables

**50mm<sup>2</sup> — 630mm<sup>2</sup>**

Terminals for MV Copper Cables

### Application

> 50mm<sup>2</sup> - 630mm<sup>2</sup> MV Copper Tube Terminals (Prefi x BTHW\_) Terminals for Indoor & Outdoor Use For applications up to 36kV

### Description

- > These connectors are manufactured from thick wall High purity oxygen free copper tube which is subsequently tin plated and waterblocked. The waterblock or waterproof seal, is provided by adding a small quantity of polyurethane resin to the base of the compression barrel.
- > Die set and catalogue numbers are marked on the connector. The compression barrels have knurl markings to indicate crimp positions.
- > The terminals are suitable for indoor or outdoor applications and are installed by circumferential die sets. The extended barrel and smooth compressions are particularly suitable for the application of protective sleeving.

### Approvals

- > BS EN 61238 (2003) class A (including short circuit)  
BS 4579 Part 1

# Cable Connectors

## Terminals for Medium Voltage Cables 50mm<sup>2</sup> — 630mm<sup>2</sup> Terminals for MV Copper Cables

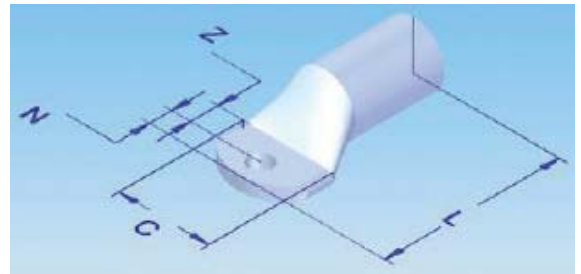

### Crimp Die Reference Table

Conductor Application (stranded conductor) mm <sup>2</sup>	Stud Size (mm)	Catalogue Number	C (mm)	N (mm)	L (mm)	Z (mm)
50	12	BTHW50C12	24.5	69.2	11.9	14.4
70	12	BTHW70C12	27.6	71.0	11.9	14.4
95	12	BTHW95C12	27.2	78.0	11.9	14.4
120	12	BTHW120C12	32.0	90.6	14.4	14.4
150	12	BTHW150C12	32.0	91.6	14.4	14.4
185	12	BTHW185C12	32.0	95.6	14.4	14.4
185	16	BTHW185C16	32.0	101.6	17.4	17.4
240	12	BTHW240C12	41.5	107.2	14.4	14.4
240	16	BTHW240C16	41.5	113.2	17.4	17.4
300	12	BTHW300C12	45.0	107.2	14.4	14.4
300	16	BTHW300C16	45.0	113.2	17.4	17.4
400	16	BTHW400C16	50.0	125.5	20.6	17.4
400	20	BTHW400C20	50.0	135.4	28.3	19.9
500	12	BTHW500C12	55.5	136.8	20.6	17.4
630	16	BTW630C16	62.7	173.0	27.0	28.0
630	20	BTW630C20	62.7	173.0	27.0	28.0

### Crimp Die Reference Table

BTHW / BTW Size	Connector	'U' Dies G10ts / E10-2000 10 ton dies	'P' Dies G14H 14 ton dies		'ED' Dies E22H 22 ton Dies		
		Die Sets	Die Sets	Adaptor	Nest	Indent	Adaptor
50	BTHW50C**	U50H	U50H	PUADP			
70	BTHW70C**	U95H	U95H	PUADP			
95	BTHW95C**	U95H	U95H	PUADP			
120	BTHW120C**	U185H	P185H	-			
150	BTHW150C**	U185H	P185H	-			
185	BTHW185C**	U185H	P185H	-			
240	BTHW240C**	U300H	P300H	-			
300	BTHW300C**	U300H	P300H	-			
400	BTHW400C**		P400H	-			
500	BTHW500C**		P500H	-			
630	BTW630C**				EDNX630C	EDP630C	ED22AD2