

LONG BELL MOUTH INSTALLATION PROCEDURE

The long bell mouth is available in three lengths and can be used to connect EFLEX Square to concrete access chambers/catchpits.

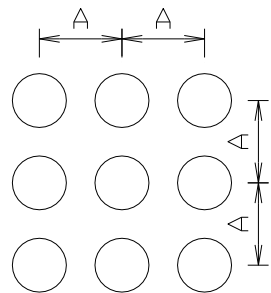

- 1 A Prepare holes in the concrete chamber according to the spacing guidelines below:



	'A' minimum				
Size	φ50	φ75	φ100	φ130	φ150
φ50	80	95	110	130	140
φ75	95	110	125	140	150
φ100	110	125	135	155	165
φ130	130	140	155	175	185
φ150	140	150	165	185	195

- 1 B Alternatively, create a single opening in the chamber to house the entire EFLEX Square sack:

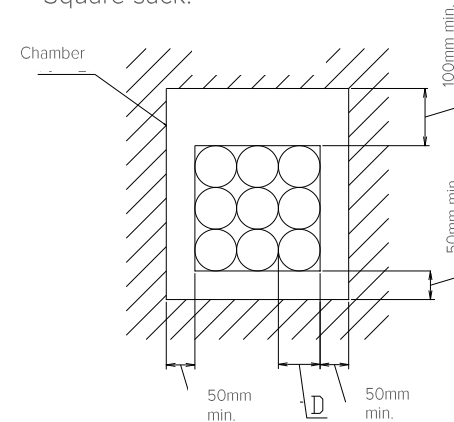

Nominal Diameter	Outer size D
50	74
75	102
100	128
130	164
150	186

- 2 Cover the single opening on the inside of the chamber with a plate or similar and hold it in place with a wooden block/spacer or similar, while work is carried out.

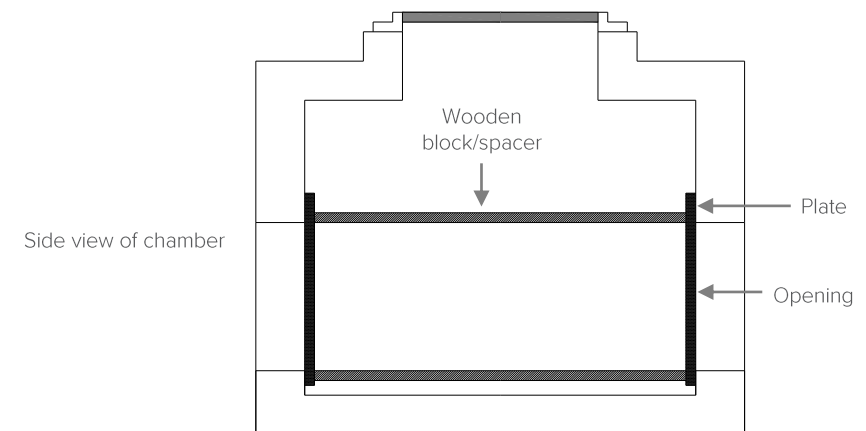

3 Connect the Long Bell Mouth to EFLEX Square

- Remove the temporary cap from the male connector of EFLEX Square.
- Lubricate the rubber seal on the male connector and the inside of female connector of the Long Bell Mouth.
- Ensure that the connection is free from dirt and debris.
- Insert the male connector into the Long Bell Mouth, in a straight line.
- Check that the connection is secure by pulling by hand in the opposite direction.

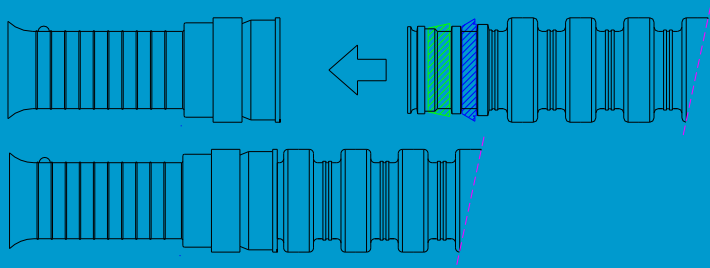

4 Remove the paper backing from the tape seal on the Long Bell Mouth and place in position:

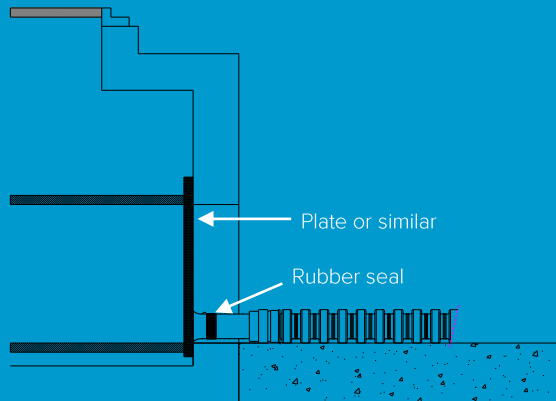

5 Position remaining Bell Mouth/EFLEX units ensuring the end of the Bell Mouth is touching the plate on the inside of the chamber.

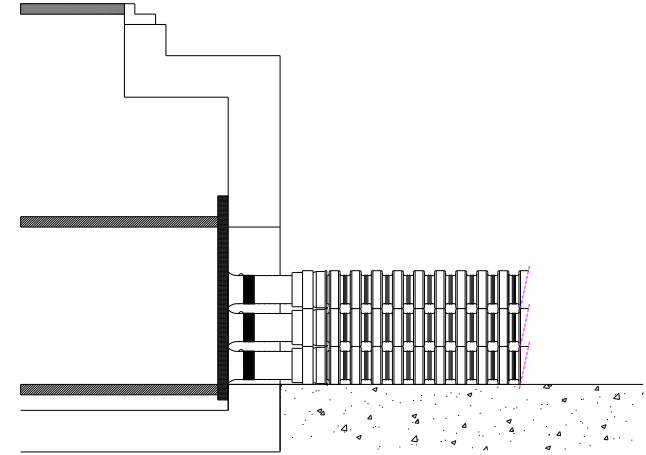

- 6 Assemble a form and pour in concrete. Allow to set before disassembling.

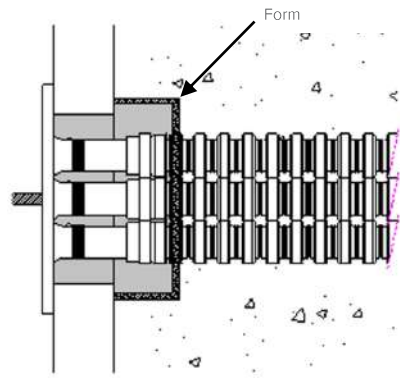

Birdseye view

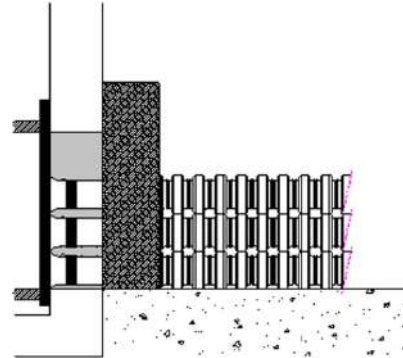

Side view

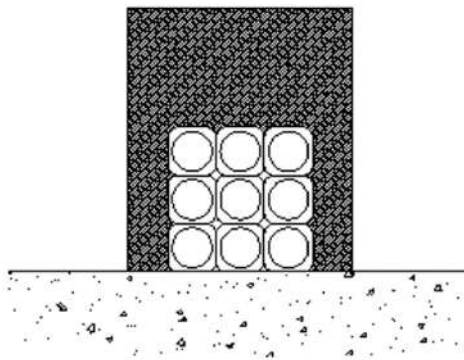

Front view

NOTE

- Ensure distance between holes is not too small, otherwise chamber strength can be compromised.
- Be careful not to damage EFLEX Square with heat from curing concrete.
- Ensure concrete does not enter the Long Bell Mouth.
- Do not use in areas at risk from ground subsidence.
- Do not use organic solvents.
- If water tightness is required. Seal the connection to the chamber with epoxy putty or similar.



EFLEX SQUARE
A FURUKAWA ELECTRIC PRODUCT