

# 400SFR-P

## INTERFACE B EQUIPMENT BUSHING

### APPLICATION

For use in equipment insulated with SF<sub>6</sub> gas.

### TECHNICAL CHARACTERISTICS

Each bushing is tested for AC withstand and partial discharge prior to leaving the factory.



### DESIGN

The equipment bushing is a moulded epoxy insulated part with a connector interface in accordance with CENELEC EN 50181. The 400SFR-P bushing has a shank outside this standard, adapted for use in SF<sub>6</sub> gas.

### SPECIFICATIONS AND STANDARDS

The plug-in type equipment bushing 400SFR-P meets the requirements of CENELEC EN 50180 and IEC 60137.

### ORDERING INSTRUCTIONS

To order the equipment bushing, simply specify the type.

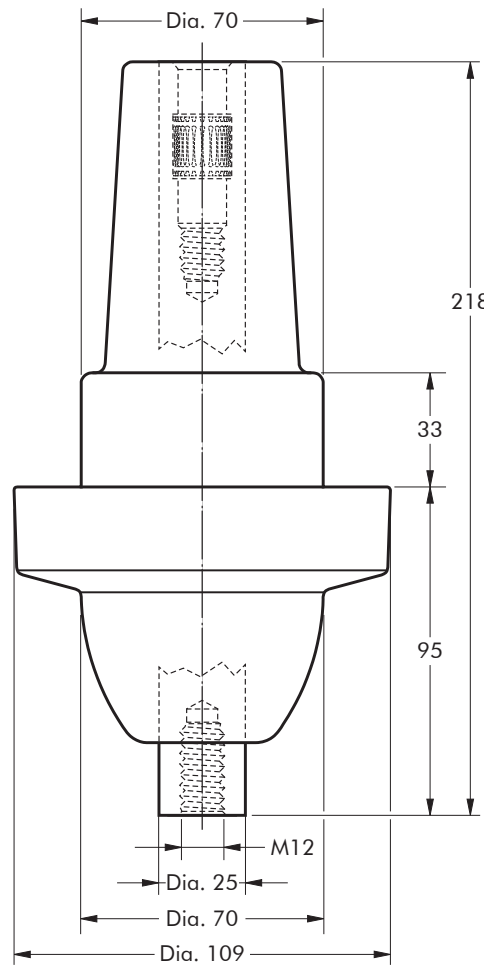

In mm.

6/10 (12) kV  
6.35/11 (12) kV  
8.7/15 (17.5) kV  
12/20 (24) kV  
12.7/22 (24) kV

Up to 24 kV - 400 A

**EUROMOLD®**

Equipment bushing type	Voltage U <sub>m</sub> (kV)	Current I <sub>r</sub> (A)
400SFR-P	12	400
K400SFR-P	24	400

01/2022

# FIXINGS FOR EQUIPMENT BUSHINGS

## 400SFR-P BUSHING FOR GAS INSULATED SWITCHGEAR

